

H10C**X302

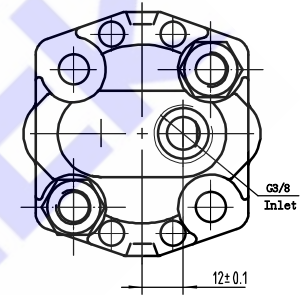

H10A**X302

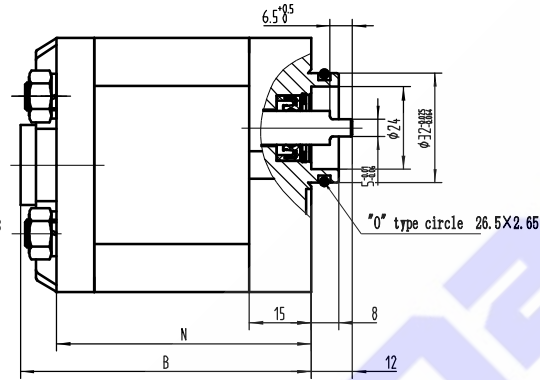
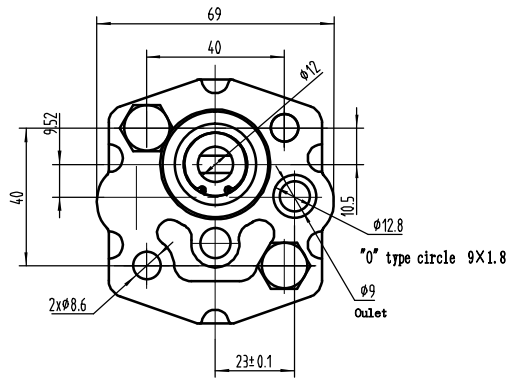
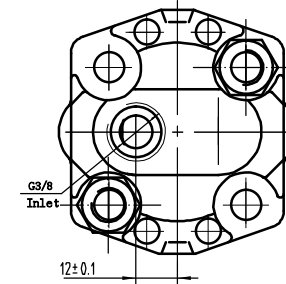
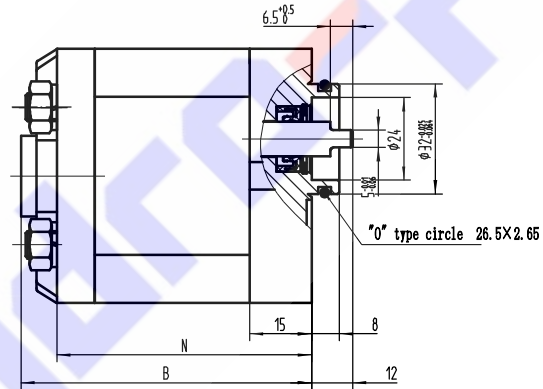
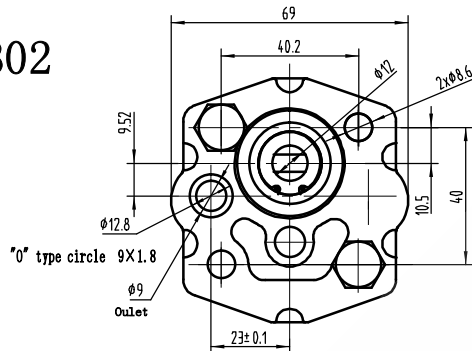

10A(C)0.8X302	0.8	67	78.5	23	25	27	3500
10A(C)1.1X302	1.1	68	79.5	23	25	27	3500
10A(C)1.3X302	1.3	69	80.5	23	25	27	3500
10A(C)1.6X302	1.6	70.5	82	23	25	27	3500
10A(C)1.8X302	1.8	71.5	83	23	25	27	3500
10A(C)2.1X302	2.1	72	83.5	23	25	27	3500
10A(C)2.5X302	2.5	74	85.5	23	25	27	3500
10A(C)2.7X302	2.7	74.5	86	23	25	27	3500
10A(C)3.2X302	3.2	77	88.5	21	23	25	3500
10A(C)3.7X302	3.7	78.5	90	20	23	25	3500
10A(C)4.2X302	4.2	81	92.5	20	23	25	3500
10A(C)4.8X302	4.8	83	94.5	19	21	23	3500
10A(C)5.0X302	5.0	84	95.5	19	21	23	3000
10A(C)5.7X302	5.7	86.8	98.3	19	21	23	3000
10A(C)5.8X302	5.7	86.8	98.3	19	21	23	3000
10A(C)6.1X302	6.1	87.5	99	18	20	22	2500
10A(C)6.3X302	6.3	88	99.5	15	17	19	2500
10A(C)6.5X302	6.5	88.5	100	15	17	19	2500
10A(C)7.0X302	7	90.5	102	13	15	17	2500
10A(C)8.0X302	8	94.5	106	12	14	16	2000
10A(C)9.0X302	9	98.5	110	10	12	14	2000
Model	Displacement ml/r	N	B	P1	P2	P3	Max. Speed r/min
				Max. Pressure (MPa)			